

*To arrange a viewing contact us
today on 01268 777400*

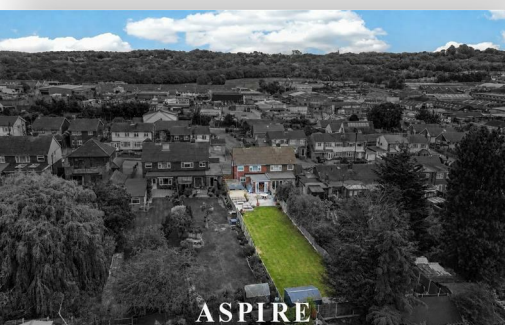

Manor Road, Benfleet Offers in excess of £450,000

Aspire Estate Agents are delighted to introduce this fantastic extended three-bedroom semi-detached family home, perfectly positioned within easy reach of local shops, amenities, schools and transport links.

Now this is what you call a family home. From the moment you arrive, the property offers instant kerb appeal with a block-paved driveway providing off-street parking, along with additional driveway space leading to the garage and a wooden gate giving access through to the rear.

Internally, the home has been beautifully improved and thoughtfully extended, creating a wonderful amount of living space for a growing family. The welcoming hallway leads into a bright and comfortable front living room, complete with a feature bay window, neutral décor and a cosy feel.

The true heart of the home is the impressive recently fitted kitchen/breakfast room, designed with both style and practicality in mind. Finished with a range of modern wall and base units, granite worktops, integrated appliances, space for an American-style fridge freezer and a central island with oak worktop, this is a space made for family life, entertaining and day-to-day living.

Flowing from the kitchen is a superb dining area, offering plenty of room for a family table and chairs, with French doors opening directly onto the rear garden. This extended layout creates a brilliant open-plan feel while still keeping each area practical and usable.

To the first floor, the property offers three well-proportioned bedrooms, with the main bedroom benefiting from built-in wardrobe storage. The recently fitted family bathroom is finished to a modern standard, featuring a panelled bath, separate corner shower, vanity unit, WC, heated towel rail and stylish tiled walls.

Externally, this home continues to impress with a stunning landscaped rear garden measuring approximately 130ft. Commencing with a paved patio area, leading onto a generous lawn and further seating area, this garden is ideal for families, summer entertaining, children playing, or simply relaxing in a private outdoor space. There is also direct access to the garage and side access back to the driveway.

Further benefits include a garage with up-and-over door, off-street parking, a modern kitchen, recently fitted bathroom, extended ground floor accommodation and a superb rear garden.

A beautiful family home offering space, style and practicality in abundance — early viewing is highly recommended.

Ground Floor

Living Room
4.04m x 3.92m
13'3" x 12'10"

Kitchen
5.95m x 3.37m
19'6" x 11'1"

Dining Room
4.25m x 2.64m
13'11" x 8'8"

First Floor

Bedroom
4.04m x 3.38m
13'3" x 11'1"

Bedroom
3.20m x 2.33m
10'6" x 7'8"

Bedroom
2.95m x 2.64m
13'0" x 8'8"

Bathroom

Manor Road

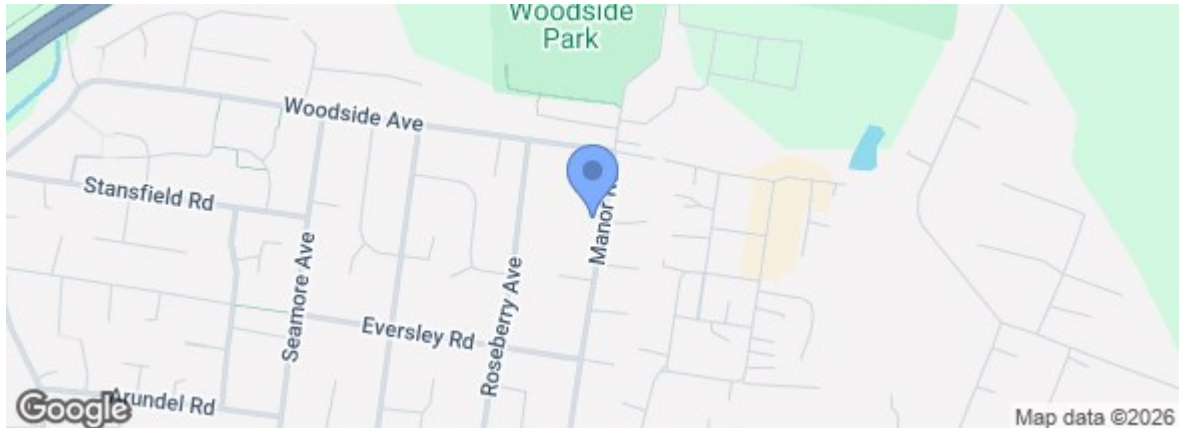
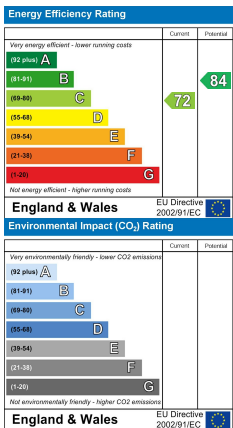
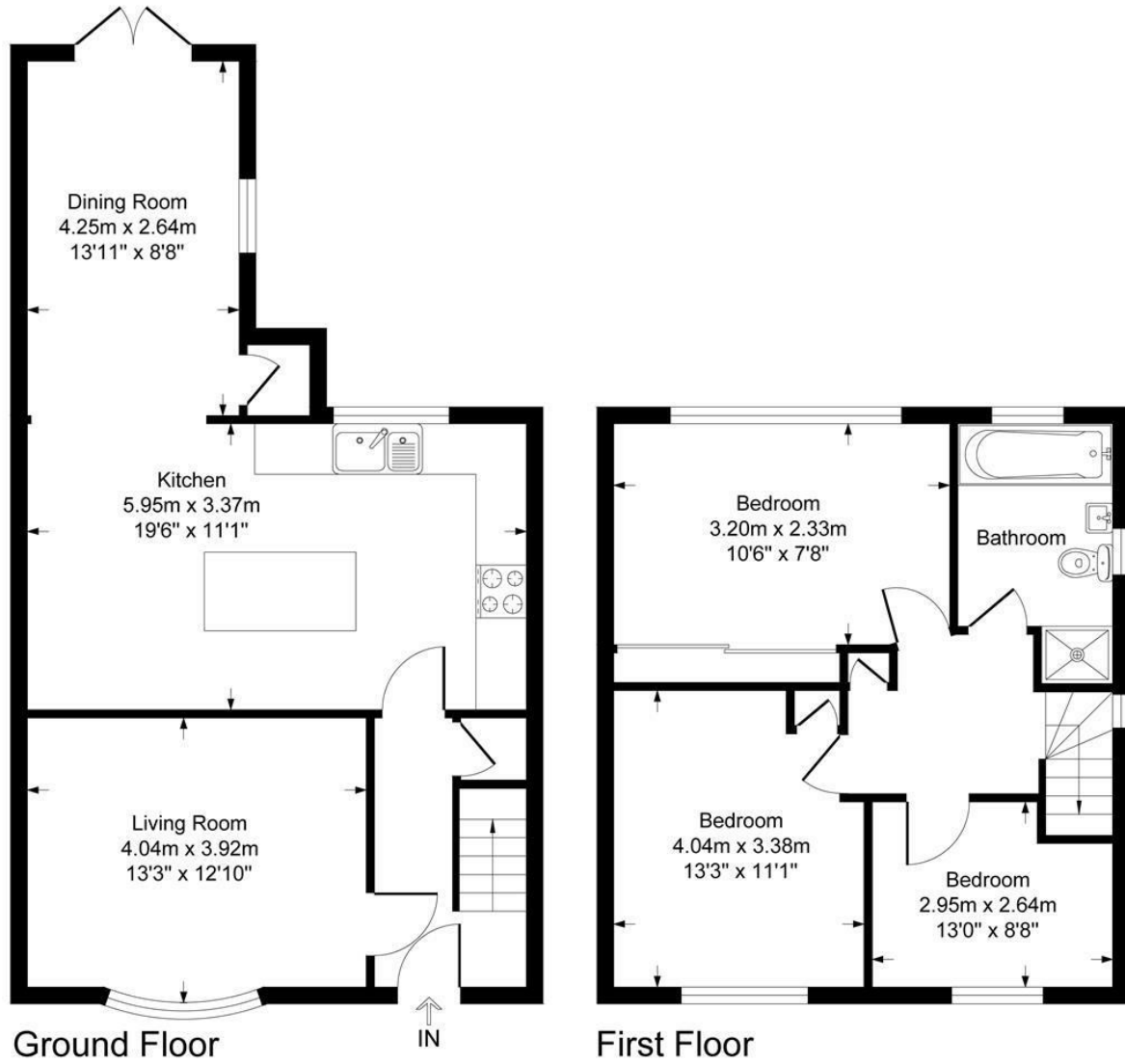

Under the Property Misdescriptions Act 1991 we make every effort to ensure our sales details are accurate but they are a general outline and do not constitute any part of an offer or contract. Any services, equipment and fittings have not been tested and no warranty can be given as to their condition. We strongly recommend that all the information provided be verified by your advisors and in particular, measurements required for a specific purpose such as fitted furniture or carpets. Please tell us if you have any problems and members of our branches will help either over the phone or in person. A copy of our complaints procedure is available on request. The details are issued on the strict understanding that any negotiations in respect of the property named herein are conducted through Aspire Estate Agents.